

## Forest River RV Wildwood X-Lite Expandables

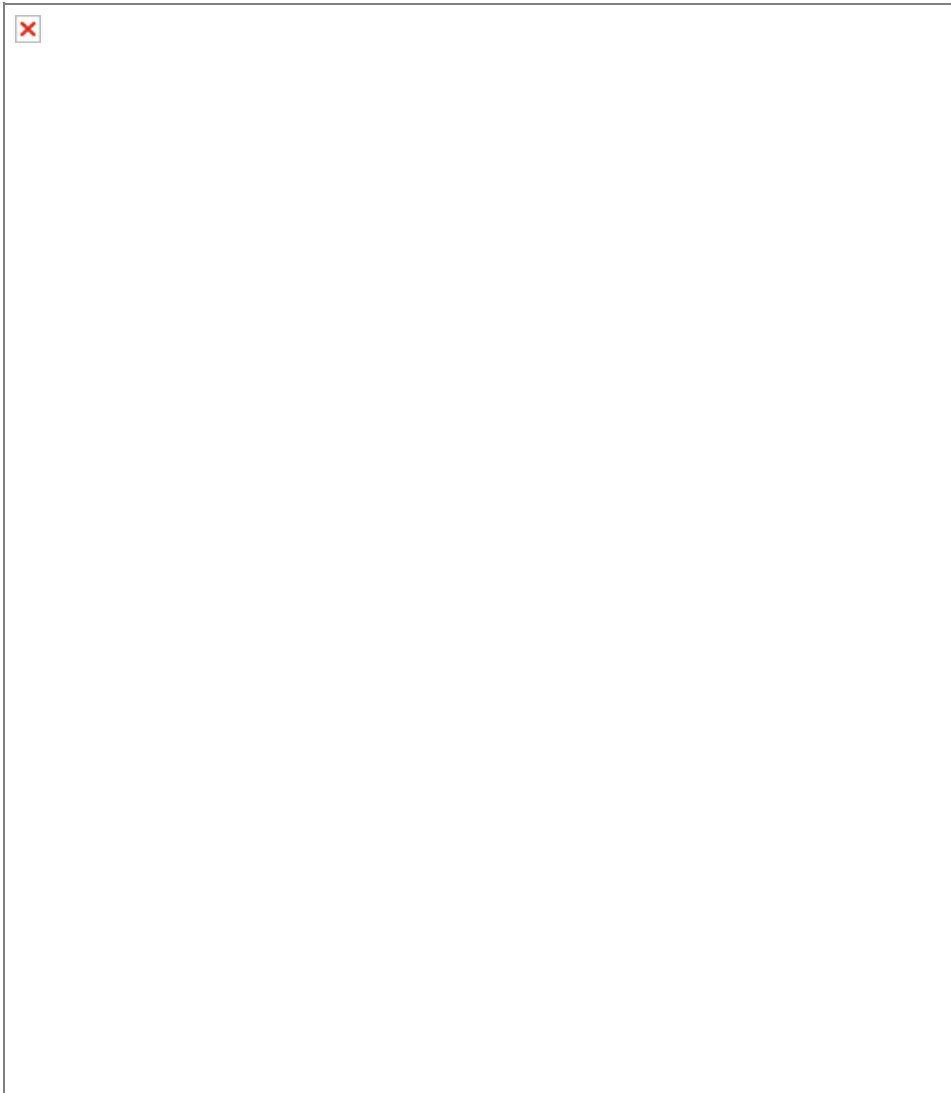

Forest River's Wildwood X-Lite travel trailers are x-tremely easy to tow, x-tremely fuel efficient, x-tremely light weight and x-tremely affordable. These trailers are packing with all the amenities you need for some serious camping and adding a whole lot of FUN on top!

The Wildwood X-Lite trailers are manufactured using state of the art Hyper-Lyte Technology. Hyper-Lyte is the fusion of innovative design and state of the art manufacturing processes, coupled with new ground breaking components that delivers an exceptional light weight RV at an unbelievable value. Choose from a wide variety of floorplan designs, you'll quickly find that all the Wildwood models offer you a quality RV made from only the finest materials because Forest River knows that is what you have come to expect.

Enjoy plenty of space with large storage areas for all your toys and extra gear. Make your next trip a real adventure and throw in a little attitude with one of America's #1 travel trailers - a Wildwood X-Lite travel trailer today!



**Brownstown 734-284-5500**  
**Birch Run 989-624-700**  
**Mt. Clemens 586-954-3600**

**Waterford 248-674-0346**  
**Wayland/Grand Rapids 269-792-9118**  
**Wixom 248-349-0900**

## 2010 Wildwood X-Lite 17EX

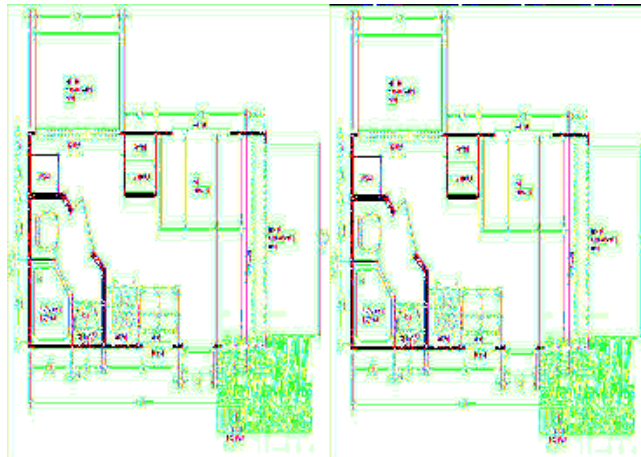

Single Slide Wildwood X-Lite Expandable TT, Rear Bath w/Neo-Angle Shower, Lav. w/Med. Cab., Toilet, Ward., Shelf, Expandable Rear Side Bed, Refrig., TV Shelf, Booth Dinette, 3 Burner Range, Dbl. Kitchen Sink, Front Expandable Bed w/Shelf, Ext. Storage and More.  
Wildwood X-Lite 17EX Specifications

Specification	Description
---------------	-------------

# Wildwood X-Lite Features:

## Standard Features (2010)

### Comfort and Convenience

- Black Framed Tinted Glass Windows
- Water Pur Whole House Water Filtration System
- Water Heater By-Pass
- 20-Gallon Electric Water Heater
- Ducted Dometic 15,000 BTU Central Air Conditioner with Quick Cool Feature
- Stain Resistant Carpet with Padding
- Armstrong ToughGuard Plan Wood Linoleum Flooring
- Flush-Floor Hydraulic Slide Rooms with Manual or Electric Override (19' Slide Outs)
- Systems Monitor Panel
- 12 Volt Lighting
- 50 Amp Electrical Service and 65 Amp 12 Volt Converter
- Solid Oak Drawer Fronts with Wood Sides
- Mortise and Tenon Cabinet Doors
- 26-inch LCD/HD T.V. (Per Floorplan)

### Kitchen

- Color Coordinated Countertop
- Raised Panel Cabinet Upper Doors
- 20" Freestanding 4 Burner Gas Range with Oven
- 18 cu. Ft. Residential Electric Refrigerator with Icemaker
- Microwave with Carousel and Range Hood
- Acrylic 60/40 Residential Style Kitchen Sink
- High-Rise Residential Style Faucet
- Sink Cover (1)
- Flip Down Silverware Storage (Per Floorplan)
- Pantry

### Living Room

- Swivel Rocker Chair(s)
- AM/FM/CD/Cassette Stereo System w/ Remote Control
- Forest River Sound System with 100 Watt Subwoofer for True Surround Sound
- Surround Sound TV Hook-up
- TV Antenna with Booster
- Cable and Satellite Ready
- 60" Glass Sliding Patio Door with Vertical Blinds
- Extra Large Picture Window at Dinette (Slide-out Models)
- Full Length Angled Overhead Cabinets with Etched Glass in Slide-Outs (Most Models)
- Large External Luggage Doors Behind Sofa and Dinette
- Extra Large 44" Pedestal Dinette for More Comfortable Dining and Sleeping
- Coordinating Wallpaper Border
- Solid Oak Slide-out Fascia

### Bedroom

- Bedspreads and Bunkspreads

- Bedroom Roof Vent
- Plywood Bunk Platforms
- TV Shelf
- Cable TV Hook-up
- Stain Resistant Carpet w/ Padding
- Solid Privacy Doors
- Solid Oak Slide-Out Fascia
- Full Length Mirrored Wardrobe Closet with 51 cu ft. Storage (Per Floorplan)
- Comfort Flex Steel Bed Frame with Lift System

## **Bathroom**

- Build-in Wood Medicine Cabinet and Mirror
- Ceiling Light with Convenient Wall Switch
- China Foot Flush Toilets
- Glass Shower Door (Neo-Angled Showers)
- ABS Tub and Shower with One-Piece Surround
- Oversized Garden Tb (Per Floorplan)
- 12" 10-Blade Fantastic Bath Fan

## **Exterior**

- Smooth Fiberglass Radius Baggage Doors with Thumb Pulls and Holdbacks
- A & E Side Awning-one Piece Vinyl
- Diamond Plate Rock Guard (n/a 392FLFB)
- One-piece Rock Guard Awning (Some Front Window Models)
- 15" Radial Tires
- Entry Assist Handle
- 30 lb. Double LP Tanks with Automatic Change Over
- LP Tank Cover
- Colored Dump Valve Handles
- City Water Filled with Brass Valve

## **Construction**

- 12" Extruded I-Beam Frame
- Cambered Chassis
- Seamless Roto-cast Holding Tanks
- Color Coded Water Lines
- 2" x 3" Floor Joists 12" on Center
- 5/8" 5-ply Tongue and Groove Plywood Floor Decking
- 2" Wall Studs Maximum 16" on Center
- Steel Framed 6' Patio Doors
- 5" Bowed Truss Roof Rafters
- 3/8" Walk-on Roof Decking
- Seamless One-Piece Rubber Roof w/ 12 Year Warranty
- Double Wipe Slide-out Seal
- R-7 Insulation Throughout (Floors, Walls, Ceilings, and Slideouts)
- Galvanized Steel Wheel Wells with Fiberglass Insulation (Except Slide-Outs)

## **Security and Safety**

- Smoke Detector
- Fire Extinguisher
- Carbon Monoxide Detector

- LP Gas Leak Detector
- Flush Door Latch with Integral Dead Bolt Lock
- Main Entry Step Light with Interior Switch
- Amber Porch Light with Interior Switch
- Main Entry Door Side Scare Light
- Screen Door with Safety Latch
- GFI Receptacles and Covered Patio Outlet
- Welded Heavy Duty Safety Chains
- Hitch Light
- E-Z Open Entry Steps
- Lockable Fiberglass Radius Baggage Doors

## Options

- Autumn Cherry or Fulton Cherry Cabinets
- Safety Glass Black Framed Tinted Windows
- Gelcoat Fiberglass Exterior w/ 16" Tires and 6.000 lb Axles
- Skylight over Tub
- Garden Tub Glass Door (per floorplan)
- Garden Shower with Glass Door (Per floorplan)
- Extra Large 8 cu-ft Double Doors RV Refrigerator
- La-Z-Boy Living Room Furniture
- Double Sofa Hide-A-Bed
- Queen Size Hide-A-Bed with Flip-up Footrests (Some Models)
- Free Standing Dinette w/4 Chairs and Flip Leaf
- Second Drawer Under Dinette (n/a with Free standing Dinette)
- Atrium Window (Some Models)
- Phone Jack
- DVD Stereo 10+2 Surround Sound System
- Bar Stools (Per Floorplan)
- Stabilizer Jacks
- Detachable Hitch
- Outside Shower
- 10-Gallon Gas/Electric DSI Water Heater (IPO 20 Gal Electric)
- Spare Tire, Carrier and Cover
- Exterior LP Gas Grill
- Ceiling Paddle Fans w/ Wall Switch
- Double Insulation (Floor and Roof)
- Nite Shades
- Thermostatically Controlled Heated Holding Tanks
- iPod Docking Station

**See us for a complete list of features and available options.**

**All features and specifications are subject to change.**